

Assembly Instructions

K1 Vehicle Set

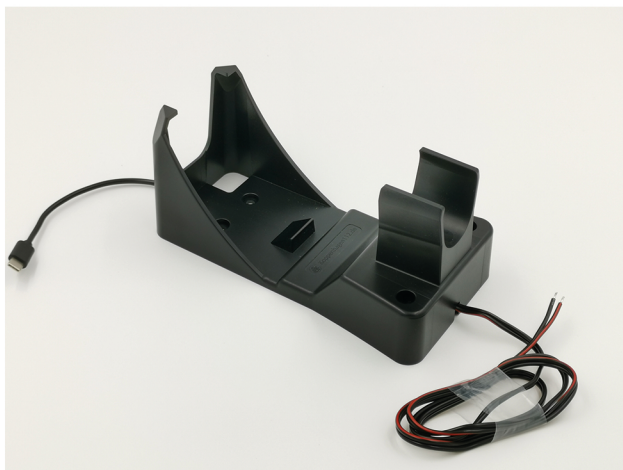

1. Introduction

Thank you for choosing the K1 vehicle set.

These assembly instructions describe the scope of delivery of vehicle set K1 and information on installation.

This vehicle set is compatible with:

- FLIR K1

Please note the instructions on page 7 for the following models:

- FLIR TG 267
- FLIR TG 275
- FLIR TG 297

Please note: The assembly instructions in other languages can be found at:

<https://www.kopenhagen.info/fwb/fahrzeugsatz-K1.php>

2. Technical Specifications

Mount

Dimensions (length x width x height)	190 mm x 96 mm x 88 mm
Weight	ca. 200 g
Material	ABS

USB-C Charging Unit

Input voltage	8-34 V/DC
Output voltage	5V/DC
Output current	3 A max.
Self-consumption	< 3 mA
Protection class IP	IP 67
Certifications	CE

3. Scope of delivery vehicle kit K1

- Mount TC ^①
- 12V/24V USB-C charging unit ^②
- 2x stainless steel A2 flat head tapping screw ^③
ISO 14585 4,8x16
- 2x stainless steel A2 flat head tapping screw ^④
ISO 14585 4,8x45
- Adhesive Pad ^⑤
- Assembly Instructions

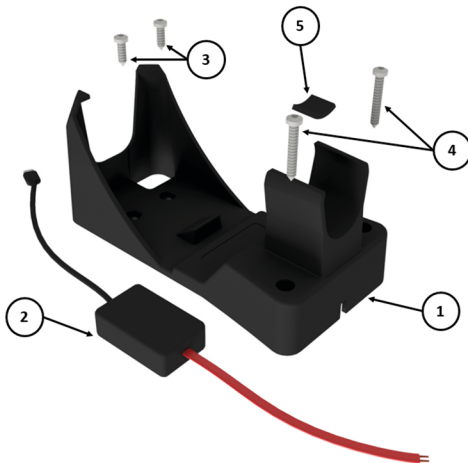

4. Notes on the assembly instructions

ATTENTION

- Do not mount in the driver's field of vision
- Do not mount in the area of the airbag equipment of the vehicle
- Select the mounting position so that in the event of a traffic accident there is no increased risk of injury to the occupants from the mount
- The driver / passenger must not be hindered by the attached bracket or cables / lines
- The mounting surface must be plane and sufficiently dimensioned to be able to securely accommodate the bracket
- Do not drill holes in the area of cables / lines
- Provide enough space for easy insertion and removal of the thermal imaging camera from the mount

5. Assembly of the mount

- a. Use a sufficiently dimensioned cable from a 12-24V voltage source to the selected mounting position of the mount
- b. You can use the enclosed drilling template to correctly position the mounting holes for the mount
- c. Drill the mounting holes
- d. Insert the USB-C charging unit into the slot on the back of the mount. The USB-C cable must be laid in the existing cable duct

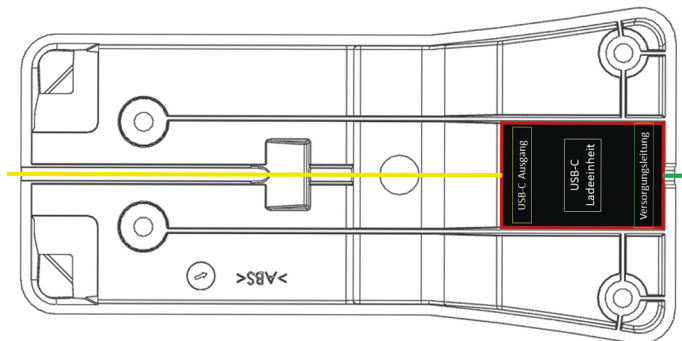

e. Align the mount over the holes and fix it adequately

Use the enclosed screws only for attachment to sheet metal components with a minimum thickness of 1.5mm!

f. Now connect the USB-C charging unit to your existing 12-24V power supply of the vehicle

During the electrical installation, it is essential that you adhere to the specifications in the operating instructions for the USB-C charging unit!

g. For use with industrial cameras TG267, TG275 and TG297 do the following step:

Remove the protective film from the adhesive pad. Stick the adhesive pad in the middle of the grip clamp (see picture).



Artikelnr.: 607791

EAN:



9900004632690

Item No.: 68302560

Article name: USB-C charging cable IP 67

Contents:

- 1 Safety instructions
- 2 Description and function
- 3 Intended use
- 4 Technical data
- 5 Electrical connection

1 Safety instructions

- Caution: Work on the vehicle electrical system may only be carried out by trained specialists.
- Improper execution of electrical connections in the vehicle can result in considerable danger.
- The charging cable must not be used if the plug, a cable or the housing of the electronics are mechanically/electrically damaged!
- The USB plug may only be plugged into suitable sockets.
- The USB plug must not be plugged into another voltage source (another charging circuit).
- The cables must not be stressed through tension.
- The charging cable should be protected with a 3A fuse at the marked strand (identification mark, red stripe, plus marking).
- When connected to a 24V vehicle electrical system, the cable length to the switch or ignition lock must not exceed 5 m.
- The manufacturer is not liable for any damage resulting from failure to observe the intended use.

2 Description and function

USB-C charging cable IP 67 water-protected for vehicle electrical systems with 12-24V with approx. 1 m connection cable and approx. 1.8 m charging cable with USB-C socket to charging and operating devices with USB-C input. With highly effective voltage converter and protection against reverse polarity, overload and overtemperature.

3 Intended use

The charging cable may only be connected to vehicle electrical systems with 12 to 24 V/DC. The device may only be used for charging and operating devices that may be charged with 5V via USB-C.

4 Technical data

Input: 8-34 V/DC

Output: 5 V/DC

Output current: 3 A max.

Power consumption: < 3 mA

Protection class IP: IP 67

Electrical connection

The marked wire (identification mark, red stripe, plus marking) is used for connection to a 12 - 24 V/DC line, this should be protected with a 3 A fuse and disconnected from the battery current via the ignition lock or a switch. In the case of a 24 V electrical system, ensure that the cable length to the switching point does not exceed 5 m to the switching point. The black wire is used for connection to the negative pole (mass).



With the CE mark, PRO CAR declares that the product fulfils the basic requirements and directives of the European regulations.